

IAM SERIES

H45 MODELS

INDEX

69	TECHNICAL DATA
70	DIMENSIONAL DRAWINGS
72	POWER CHARTS
73	ORDERING INSTRUCTIONS

www.Laheghi.com

IAM H45 - TECHNICAL DATA

MODEL	N° of pistons	Displacement cc/ rev	Specific Torque Nm/ bar	Pressure			Speed		Max Case Pressure bar	Max Power hp	kW	Dry Weight kg	Inertia moment of rotating parts kg cm ²	
				Max Cont. bar	Max Int. bar	Peak bar	Max Continuous rpm	Peak rpm						
IAM H45	1100	5	1183	18,8	250	300	350	350	400	6	161	120	118	380
	1400	5	1376	21,9	250	300	350	300	350	6	161	120	118	380
	1500	5	1529	24,3	250	300	350	300	350	6	161	120	118	380
	1600	5	1690	26,9	250	300	350	275	325	6	161	120	118	380
	1800	5	1816	28,9	250	300	350	250	300	6	161	120	118	380

www.Laheghi.com

IAM H45 - DIMENSIONAL DRAWINGS

IAM 1100 – 1400 – 1500 – 1600 – 1800 H45

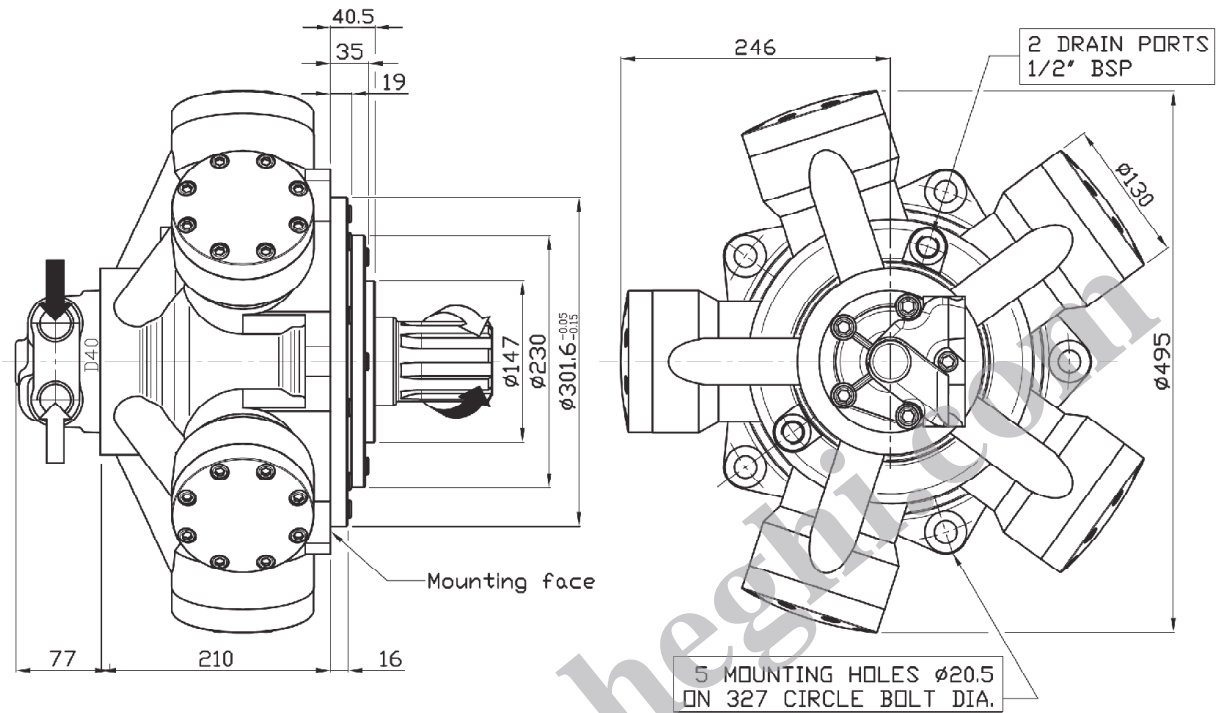

SHAFT OPTIONS

A0: Standard splined shaft

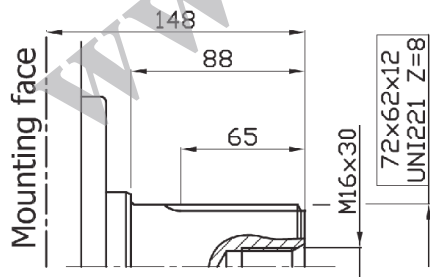

A1: Splined shaft on request

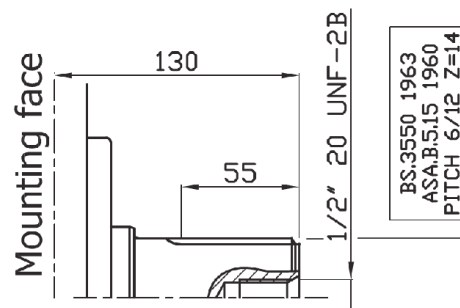

IAM 1100/C – 1400/C H45

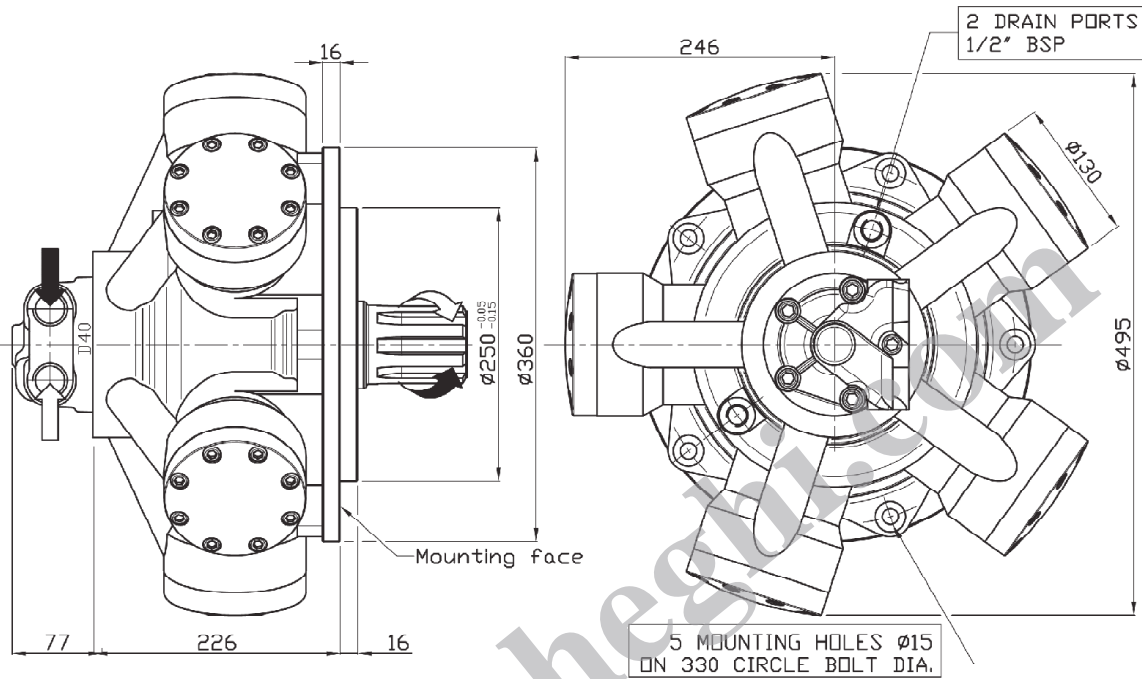

SHAFT OPTIONS

A0: Standard splined shaft

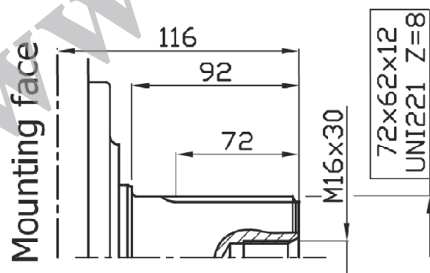

FL3: Connection block

Connection block, fitting D55 distributor, for motor MR 1100/1400/1600/1800/2100

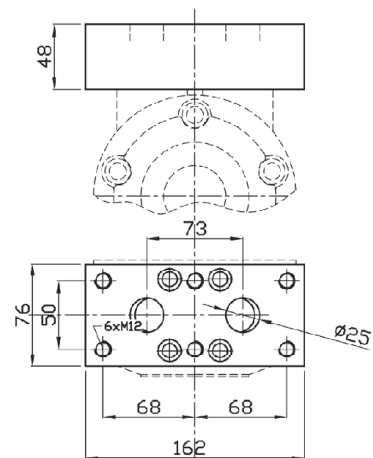

IAM H45 - POWER CHARTS

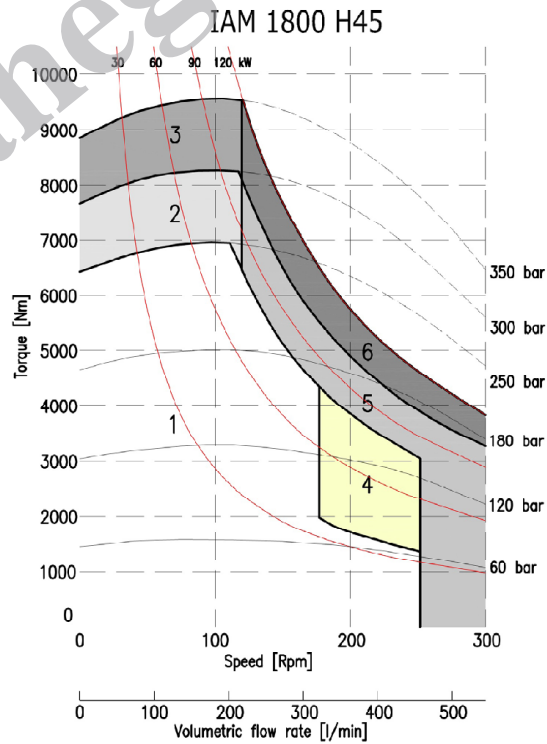
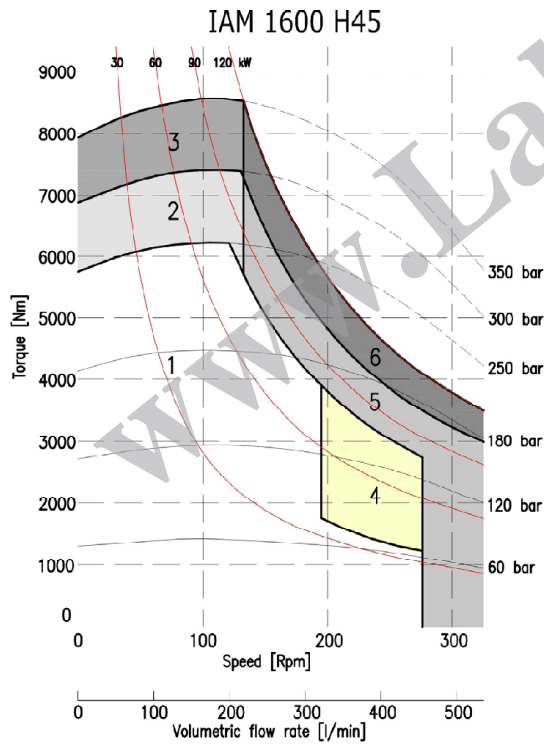
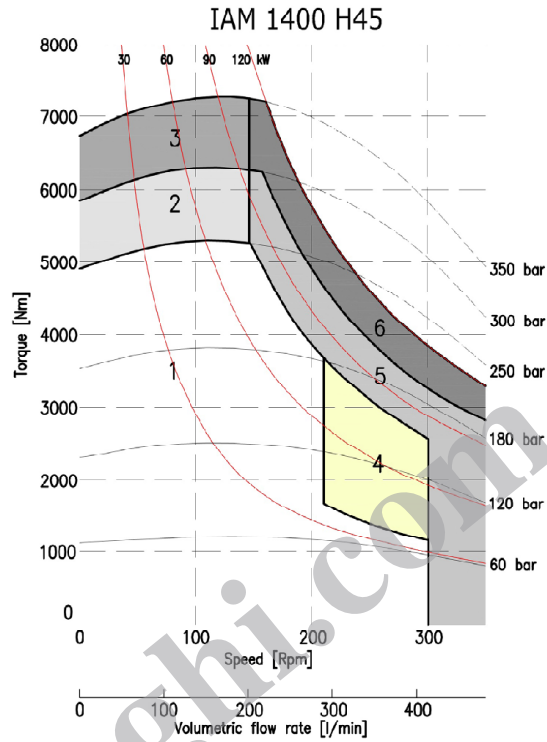
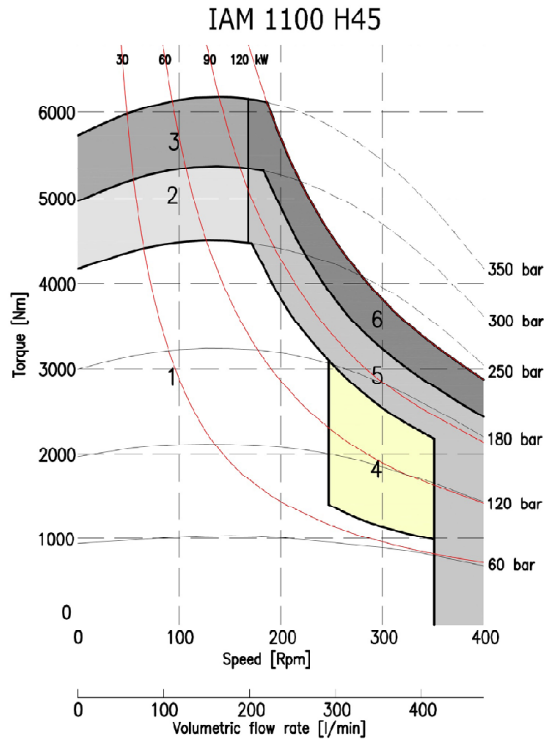

1	Continuous operation
2	Intermittent operation for period 3-5 minutes every 10-15 minutes
3	Intermittent operation for very short period (3-5 seconds every 10-15 minutes)

4	Continuous operation with flushing
5	Intermittent operation for period 3-5 minutes every 10-15 minutes with flushing
6	Intermittent operation for very short period (3-5 seconds every 10-15 minutes) with flushing

IAM H45 - ORDERING INSTRUCTIONS

IAM	---	/_	H45	A_	D_--	---	SB_
Model IAM							
Displacement 1100 cc/rev 1400 cc/rev 1500 cc/rev 1600 cc/rev 1800 cc/rev							
Interchangeability /C							
Housing H45							
Shaft A0 – Standard splined shaft A1 – Special splined shaft							
Distributor D40 – 1" BSP D47 – SAE 1" 3000 psi flange D75 - SAE 1 1/2 " 3000 psi flange							
Tachometer TA TB EST EST.30 J							
Spline billet SB6 – 62 UNI 221 SB7 – BS.3550							

EXAMPLE :

IAM 1400 H45 A0 D40

IAM 1100/C H45 A1 D40 TA